

Hi - Power



AIR ARMS, STATION ROAD INDUSTRIAL ESTATE,
HAILSHAM, EAST SUSSEX, BN27 2ES, ENGLAND.

Telephone (0323) 845853

MANUFACTURERS OF QUALITY AIR WEAPONS

SPARE PARTS CATALOGUE

INCORPORATING INSTRUCTIONS FOR RAPIDE
AND FIREPOWER AUTOLOAD SYSTEM

GENERAL OPERATION

To cock the gun place butt on thigh, depress cocking arm, release catch. Grasp the top of the cocking arm and pull it out and away from the gun cylinder until it will travel no further. Gun is now cocked. Return arm to closed position. Load pellets as per the instructions on next page. Be sure of what lies beyond your target before squeezing the trigger.

TRIGGER ADJUSTMENT — ALL MODELS

The trigger adjusting screw is located at the rear of the cylinder between the sight grooves. Using the allen key provided, turn the allen screw clockwise to increase the trigger pull, or anti-clockwise to reduce pull. Always ensure tap is in upright position when adjusting the trigger. Note: the rear sight has to be removed to gain access to the sight adjusting screw.

WARNING: The Trigger adjustment is critical to the correct operation of the rifle and is best left at the factory setting. However, if adjustment is made, note should be taken that excessive adjustment in either direction will make the gun inoperative and excessive adjustment in an anti-clockwise direction will also prevent the rear sight fitting.

SIGHT ADJUSTMENT — ALL MODELS

The foresight can be adjusted laterally by slackening the fixing screw and twisting the sight into the required position.

The rear sight is adjusted with thumb screws for elevation and windage.

SAFETY CODE

1 Treat all air-weapons as if loaded

4 Always be sure what lies behind your target

Parts list, June 1983.

NOTE PART NUMBERS MUST BE QUOTED WHEN ORDERING SPARES

AR 100A	Safety ratchet cam assembly	AR 203	Magazine slide supplied with AR 206
AR 101	Piston pull & safety ratchet pivot & buffer pin	AR 203A	Plastic stock butt plate
AR 102	Cocking lever pivot bush	AR 204	Butt plate screw, rear, right fixing screw
AR 105	Front sear and trigger sear circlip spacer	AR 205	Wood stock
AR 106	Front stock clamp spacer	AR 206	Magazine assembly
AR 107	Front stock clamp spacer	AR 207	Magazine fixing screws
AR 109	Cocking lever pivot pin	AR 209	Magazine slide fixing screw
AR 112A	Long sear lift pin	AR 211A	Piston O-ring
AR 112B	Tap, 22 cal.	AR 211	Stock (ABS)
AR 112C	Tap, 20	AR 212	Stock top cover
AR 112D	Tap, 22 Firepower & Rapide only	AR 213	Stock top cover Combat only
AR 122B	Barrel, 177 cal.	AR 213A	Cylinder assembly
AR 122C	Barrel, 22 cal. Combat	AR 215	Firepower & Rapide rear clip fixing screw
AR 122D	Barrel, 22 cal. Combat	AR 222A	Front sight—Rapide, Supra, Woodman
AR 122E	Barrel, 20 cal.	AR 230W	Front sight—Firepower, Hi-power
AR 123	Front stock clamp	AR 230A	Front sight—Combat
AR 124	Clamp screw	AR 230C	Front sight—for use with silencer
AR 125	Clamp screw nut	AR 230S	All models except Combat
AR 126	Front sling swivel (ABS Stock)	AR 231	Front sight fixing screw
AR 126A	Rear sling swivel (ABS Stock)	AR 232	Muzzle break (text. Combat)
AR 130	Tap spring	AR 233	Rear sight assembly
AR 131	Tap screw	AR 235	Wood stock sling swivel
AR 132	Tap lever	AR 236	Wood stock rear sling swivel boss
AR 133	Cocking lever	AR 237	Wood stock rear sling swivel screw
AR 134	Piston pull	AR 238	Wood stock front sling swivel boss
AR 135	Circlip (large)	AR 239	Wood stock front sling swivel inner
AR 138	Long sear & locking catch spring	AR 240	Wood stock fixing screw
AR 139	Locking catch spring pin	AR 241	Firepower & Rapide magazine tube
AR 140	Locking catch & chassis spring pin	AR 242	Firepower & Rapide magazine tube pin
AR 143	Locking catch spigot	AR 243	Firepower & Rapide loading port cover
AR 144	Rear-plug retaining screw	AR 244	Firepower & Rapide magazine tube clip insert
AR 144A	Barrel fixing screw	AR 245	Firepower & Rapide barrel bracket
AR 146	Trigger sear	AR 246	Firepower & Rapide barrel bracket screw
AR 147	Trigger sear	AR 248	Firepower & Rapide tube clip pin
AR 150	Safety ratchet	AR 249	Firepower & Rapide tube clip circlip
AR 151	Safety ratchet spring	AR 250	Firepower & Rapide rear clip
AR 153	Long sear & trigger sear pivot pin	AR 251	Firepower & Rapide rear clip
AR 154	Circlip (small)	AR 252	Mainspring
AR 169	Piston	AR 253	Mainspring pad
AR 170	Trigger adjusting pin	AR 254	Mainspring sleeve
AR 171F	Plastic stock fixing screw front	AR 255	Locking catch assembly
AR 172	Plain washer	AR 256	Locking catch button
AR 173	Spring washer	AR 257	Silencer (all models except Combat)
AR 175	Long sear	AR 258	Scope arrester block
AR 176	Long sear lift	AR 259	Safety ratchet buffer
AR 179	Barrel fixing screw pad	AR 260	Locking catch button pin
AR 180	Trigger guard	AR 261	Silencer spacer (required if field sights removed)
AR 183	Trigger guard fixing & pellet stop fixing screw	AR 262	Trigger adjusting pin
AR 184	Trigger guard and barrel bracket nut	AR 263	Trigger adjusting screw
AR 201	Muzzle break Combat only	AR 264	Rear plug retaining pin
AR 202	Muzzle break screw	AR 265	Allen key set (not illustrated)
AR 203	Rear plug pin extractor screw (not illustrated)	AR 266	

PLEASE NOTE: To fit silencer it is necessary to use AR 230S front sight or if field sights are not required to use AR 261 spacer.

WARNINGS

Always ensure weapon is uncocked before commencing either maintenance or disassembly.
 Never discharge weapon against an out of alignment loading tap or an empty chamber.
 Either may cause internal damage.

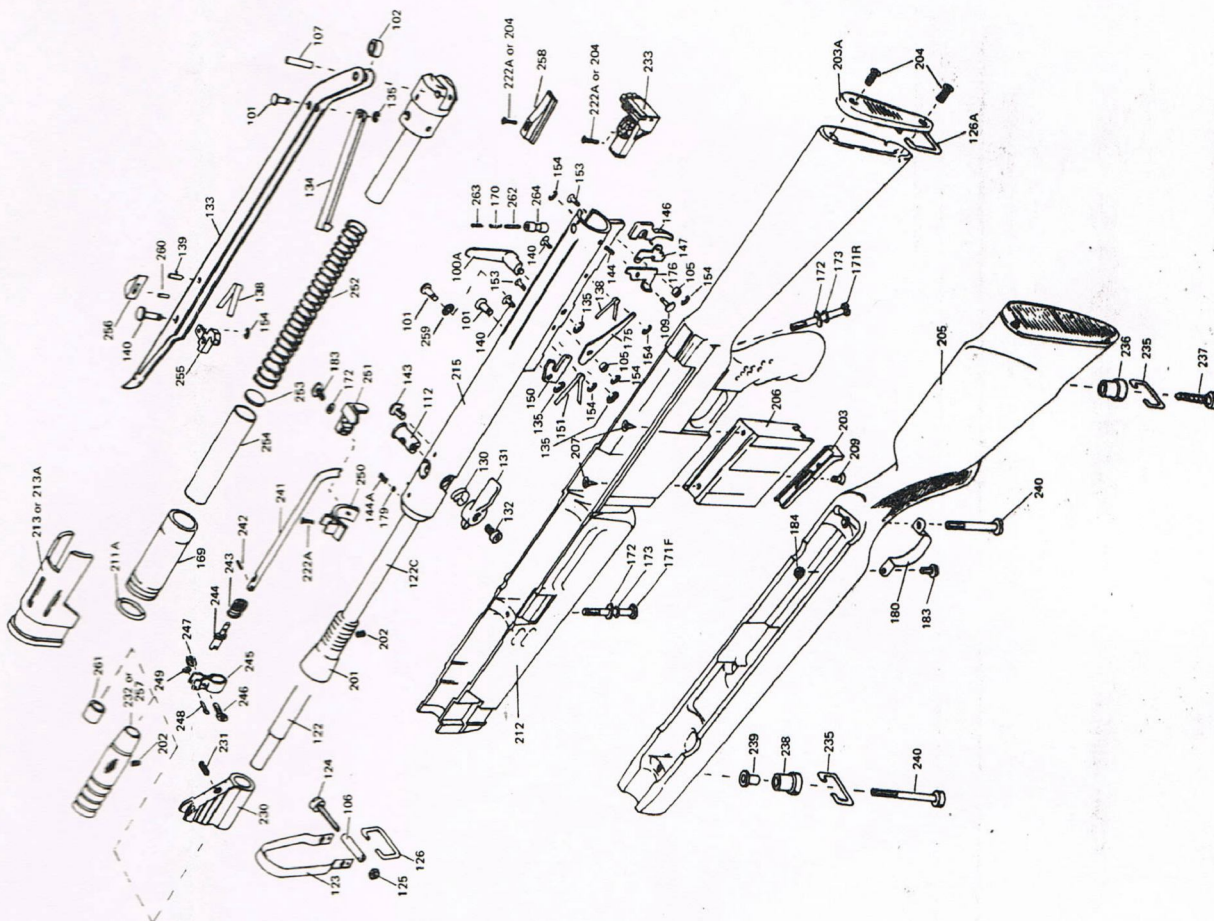

FOR SMOOTH, PROBLEM FREE OPERATION FOLLOW THE RECOMMENDED PROCEDURE:

1. **CLOSE** loading tap.
2. Slide back cover from loading port in tube.
3. Insert pellets **NOSE TOWARDS LOADING TAP** (tube holds approximately 35 pellets. Autoload will accept most brands of pellets. If trouble is experienced try a different brand.
4. Re-position cover over loading port.
5. Cock gun in normal way (in tilted up position, see Fig. 1). **THIS POSITION IS VERY IMPORTANT TO ALLOW PELLETS TO FALL TOWARDS LOADING TAP.**
6. Return gun to level position (see Fig. 2). Now simply flick open tap hard against stop **ONCE** only, then close tap smoothly to feed pellet into tap.
7. Gun is now ready to **SHOOT**.
8. Repeat instructions 5, 6 & 7 until magazine is empty.

Remember – **COCK, LOAD, SHOOT.**

THE MOUNTING BRACKETS ARE ACCURATELY POSITIONED ON ASSEMBLY AND SHOULD NOT BE MOVED UNLESS ABSOLUTELY NECESSARY !

If the 'Autoload' system fails to operate:

- * Check that tube is accurately positioned directly along centre line of gun and locates in pellet hole correctly.
- * Check that front stock screw is tight.
- * Check that pellet stop screw is tight.
- * Re-read operating instructions carefully – in particular ensure that the cocking and loading positions are as illustrated.
- * Poor quality or damaged pellets will foul the precision timing mechanism of the autoload and cause loading problems.
- * Inspect tap hole and tube outlet for lead fragments or burns.

Clearing 'Autoload' of damaged pellets:

Turn the Firepower or Rapide onto one side.
Carefully prise tube out of rear clip, swing tube forward.
Remove all traces of damaged pellets from tap area.
Re-position tube carefully.

Every 250 rounds, carefully clean and lightly oil the autoload.

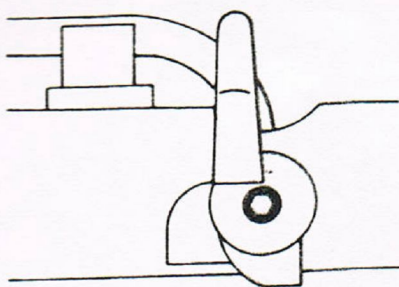

AFTER SHOOTING, ALWAYS STORE
WITH LOADING TAP FULLY OPEN –
FAILURE TO DO THIS WILL DAMAGE
THE AUTOLOAD SYSTEM.

TAP LEVER IN
OPEN POSITION

INSTRUCTIONS FOR REMOVING AND RE-FITTING MAIN SPRING

1. Remove rear sight. Fixing screw is located under elevation thumbwheel.
2. Pull cocking lever to half cocked position.
3. Push safety ratchet lever forward with thumb, Fig. 1.
4. Pull on cocking lever slightly to disengage safety ratchet and then **CAREFULLY** close cocking lever fully.
5. Knock out cocking lever pivot pin with hammer and soft drift, Fig. 2.
6. Slide piston pull forward to end of slot in cylinder and remove complete with cocking lever.
7. Remove trigger adjusting screw, spring and pin and then insert removing screw, Figs. 2 and 3.
8. Remove rear plug pin locking screw, Fig.2.
9. Apply pressure to rear plug to overcome mainspring preload and pull out rear plug pin, Fig. 3.
10. Release pressure from rear plug and the mainspring will push the rear plug free, Fig. 4.

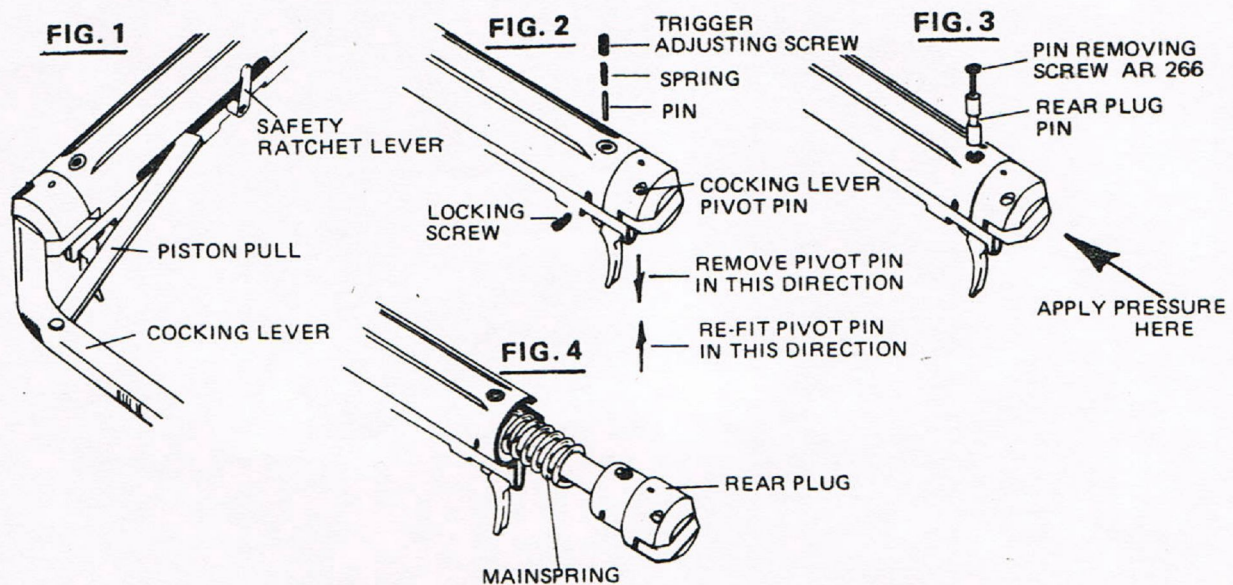

Reverse the above instructions to re-fit, but note that the cocking lever pivot pin is re-fitted from below, Fig. 2.

LUBRICATION AND MAINTENANCE IS ESSENTIAL FOR RELIABLE PERFORMANCE

LUBRICATION*

Oil all pivot points. Lubricate piston through cylinder slot. Lubricate cocking arm catch. Lubricate tap when in open position then close tap and stand gun, muzzle upwards for as long as possible. Lubricate trigger mechanism.

*Use only silicone based oils.

MAINTENANCE*

Keep barrel clean and free of dirt. Wipe all external metal parts with oil saturated cloth. Ensure that all screws are tight. Check tap for alignment.

*Carry out maintenance procedure after each period of use.